



# Gin Gin Recreational Reserve

## Improvement works – carpark and toilet, February - April 2021

### Project Details

The construction of a formal carpark and toilet block in Gin Gin Recreational Reserve will improve vehicle mobility and levels of service for community members visiting the park. The upgrades improve park assets to meet community recreation requirements and complement existing park facilities.

### Carpark and toilet

A new entrance will be created off May Street to access a designated parking area. The internal road will have a cul-de-sac turn around and formalised angle car parking including disability parking. An existing shelter has been re-positioned to accommodate the new two cubicle disability compliant toilet.

A pedestrian pathway will be constructed from the carpark to the new toilet block and connect to the existing barbecue shelter and playground to allow for safe navigation for reserve users.

Additional work will include a new viewing platform with seating at the skate bowl, improved drainage and safety handrails.

### Access

During construction, access to the shelters, barbecues and playground will be via steps and a landing from a marked temporary carpark off May Street. There will be no access to the skatepark.

The Gin Gin carpark and toilet upgrades is a joint initiative of Bundaberg Regional Council and the Queensland Government.



**Queensland  
Government**

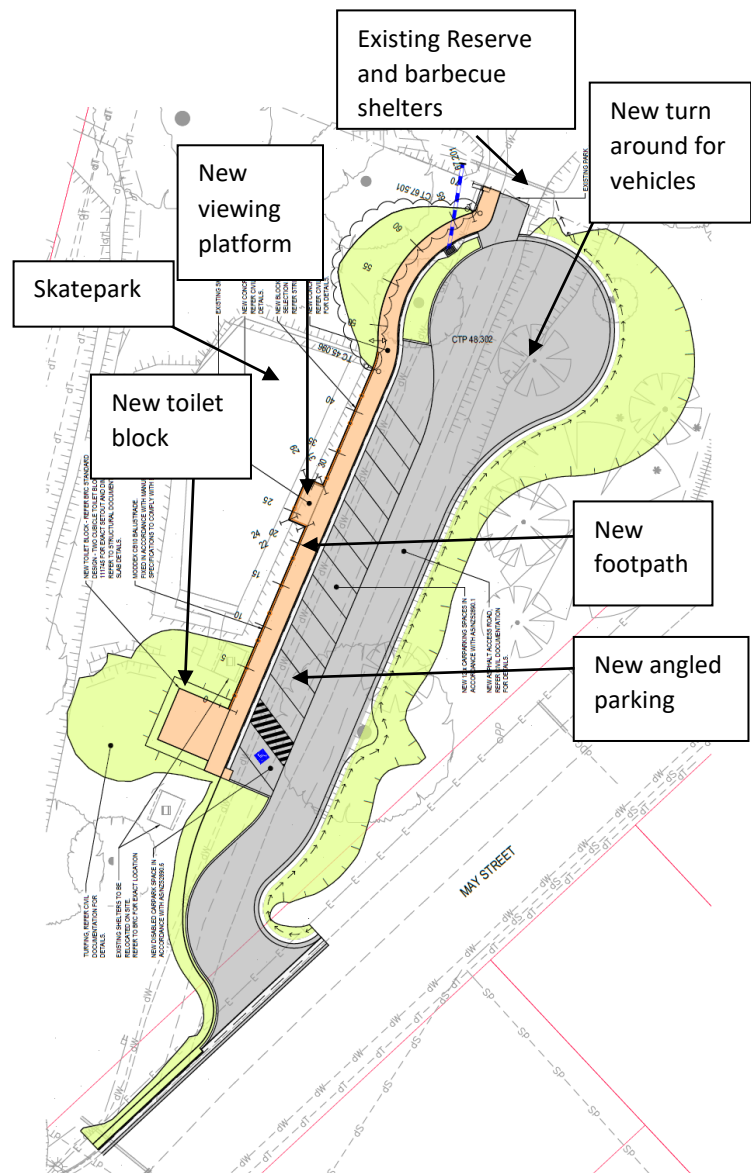

### For more information

Call us on 1300 883 699

Email: [parkadministration@bundaberg.qld.gov.au](mailto:parkadministration@bundaberg.qld.gov.au)

Project Manager: Mike Paul, Coordinator Parks, Projects & Assets

Division 3 Councillor Cr Wayne Honor: 0488 539 224

Portfolio Councillor: Cr Wayne Honor 0488 539 224